

# MARRYAT & SCOTT EGYPT FACTORY

**Marryat & Scott**

**Fire Rated Steel Doors & Windows  
Manufacture, Established in 1984  
Marryat & Scott Have A Test Certification  
from Intertek Laboratories Inc. USA  
Very Similar to UL 10A/10B, UL 9,  
UBC 7-2 & UBC 7-4**

# Marryat & Scott

## Egypt Factory

Marryat & Scott Egypt Factory was established in 1984 on 20,000 m<sup>2</sup> of land situated at KM 28 of the Cairo – Alexandria desert road. The factory production is specialized in manufacturing of all sheet metal work products including:

- Steel doors and frames
- Fire rated steel doors
- Fire and non-fire rated steel windows
- Fire steel doors and windows assembly mounted in a gypsum partition wall
- Vault and grill doors
- Sliding steel doors
- Stainless steel cladding doors

The factory is equipped with computerized and very modern specialized machines to produce very high technical products with excellent quality.

It is not by chance that we are specialized in fire rated doors, our long experience, the possibilities offered by our integrated studies and design office, enable us to satisfy customer's needs. The custom-made together with the complete range of fire-rated doors we manufacture are all evidence of this.

We have a test certificates from Intertek ETL SEMKO laboratories Inc. U.S.A.

These certificates and approvals demonstrate our ongoing continued commitment to provide quality products and service to our customers



## UL 10A/10B UBC 7-2 ASTM 2074

1- 120 MINUTE fire resistance test of hinged steel door was tested successfully by Intertek ETL SEMKO U.S.A met the conditions outlined in NFPA 252 standard methods which is identical or very similar to the following standard test methods

## UL9 UBC 7-4 ASTM E 163

2- 120 MINUTE and 60 MINUTE fire resistance test of glass steel window assemblies was tested successfully by Intertek laboratories Inc. U.S.A accordance with NFPA 257 standard methods which is identical or similar to the following standard test methods

## UL9 UBC 7-4 ASTM E 163

3- 60 MINUTE fire resistance test of a fire door and window assembly mounted in a gypsum partition wall tested successfully by Intertek laboratories Inc. U.S.A accordance with NFPA 252 and NFPA 257.

4- 90 MINUTE fire resistance test of a fire door and frame assembly was tested successfully by Intertek Laboratories Inc. U.S.A. accordance with NFPA 257 standard methods which is identical or similar to the following standard test methods



# Certificates



## Certificate of Compliance



You have been awarded:

**Intertek Warnock Hersey Mark for fire resistant Windows**  
NFPA 252 (2008) UL 10B (2009) UL 10C (2015)  
**Certificate number: WH116 - 21930703**

This is a certificate of conformity to verify that the holder has successfully completed the requirements of the above standard which include the testing of products, the initial assessment of their Factory Production Control and are subject to continuing annual assessments of their continued Factory Production Control compliance and testing of samples of products taken from production (as applicable to the scheme) and has been registered within the scheme for the products detailed in the accompanying schedule.

**Organization:**

Kone Corporation - Maryat & Scott Egypt S.A.E  
 Abu Rawash Road, Kilo 28 Cairo Alexandria Desert Road  
 Giza  
 Egypt

**Product: Kone 2 Hour Rib-Stiffened, Insulated, Steel Fire Door**  
**Maximum size: 120 minutes**  
**Single Swing: 1020mm x 2400mm (39" wide x 80" high)**  
**Standard Pair: 2100mm x 2400mm (79" wide x 80" high)**

**Certification body: Intertek Testing Services NA, Ltd.**  
**Initial registration: April 1<sup>st</sup>, 2013**  
**Date of expiry: April 1<sup>st</sup>, 2018**  
**Issue status: 2**

**Dustin Behling**  
Certification Coordination Manager



**13<sup>th</sup> July 2016**  
Date

[www.intertek.com](http://www.intertek.com)

Registered address:  
 Intertek Testing Services NA, Inc. 8431 Murphy Drive, Midvale, UT 84045 USA

This certificate was issued in accordance with the requirements of the Intertek Warnock Hersey Mark for fire resistant products. It is a condition of the scheme that the holder of this certificate must comply with the requirements of the scheme and must maintain the Factory Production Control system in accordance with the requirements of the scheme. The holder of this certificate must also comply with the requirements of the scheme and must maintain the Factory Production Control system in accordance with the requirements of the scheme. The holder of this certificate must also comply with the requirements of the scheme and must maintain the Factory Production Control system in accordance with the requirements of the scheme.



## Certificate of Compliance



You have been awarded:

**Intertek Warnock Hersey Mark for fire resistant doors and door sets**  
ASTM E152-4 (UL 10C) (1997) (CSFM 43.7 UL 10C) (1997) (ASTM E209 (2005) NFPA 252 (2008) CEN EN 15925 (2005) EN 15925 (2005) UL 10C (2015) (2009) (UL 10C (2015))  
**Certificate number: WH113 - 21930702**

This is a certificate of conformity to verify that the holder has successfully completed the requirements of the above scheme which include the testing of products, the initial assessment of their Factory Production Control and are subject to continuing annual assessments of their continued Factory Production Control compliance and testing of samples of products taken from production (as applicable to the scheme) and has been registered within the scheme for the products detailed in the accompanying schedule.

**Organization:**

Kone Corporation - Maryat & Scott Egypt S.A.E  
 20 Abu Rawash EL, SECCO Mohandessien  
 Giza EG 12411  
 Egypt

**Product: Kone 2 Hour Pressed Steel Fire Door Frames**  
**Maximum size: 120 minutes**  
**Single Swing: 31" wide x 80" high**  
**Standard Pair: 70" wide x 80" high**

**Certification body: Intertek Testing Services NA, Ltd.**  
**Initial registration: April 1<sup>st</sup>, 2013**  
**Date of expiry: April 1<sup>st</sup>, 2018**  
**Issue status: 1**

**Dustin Behling**  
Certification Coordination Manager



**04/01/2013**  
Date

[www.intertek.com](http://www.intertek.com)

Registered address:  
 Intertek Testing Services NA, Inc. 8431 Murphy Drive, Midvale, UT 84045 USA

This certificate was issued in accordance with the requirements of the Intertek Warnock Hersey Mark for fire resistant products. It is a condition of the scheme that the holder of this certificate must comply with the requirements of the scheme and must maintain the Factory Production Control system in accordance with the requirements of the scheme. The holder of this certificate must also comply with the requirements of the scheme and must maintain the Factory Production Control system in accordance with the requirements of the scheme. The holder of this certificate must also comply with the requirements of the scheme and must maintain the Factory Production Control system in accordance with the requirements of the scheme.

# Introduction

## Steel Doors and Frames

Steel door and frame products have earned an enviable reputation with architects engineers and construction trade professional around the world. It provides a wealth of benefits and competing products. When specifying door and frame systems for you next project, consider the many demonstrated benefits of steel products.

Steel products are rugged, long lasting and offer great endurance through time. They resist environmental stress like heat and humidity that adversely impact other door and frame products. Steel products are easy to maintain and ensure virtually trouble free operation for many years. Steel doors and frame products are also an ideal solution to any degree of security.



To meet the varied needs of the construction industry, Marryat & Scott manufactures a wide range of steel door and frames for interior and exterior use. Marryat & Scott doors are the most reliable doors manufactured, by using only the highest quality materials and manufacturing techniques. Steel doors are produced in many sizes, gauges and designed to meet the needs of architects, owners and contractors.



## Application of Doors and Frames

The application of Marryat & Scott door and frame products are appropriate and virtually limitless. From Apartments Buildings, Hotels, Schools, Courthouse, Office Buildings, Dormitories Military Barracks, Detention Centers, Prisons, Department Stores, Warehouses, Hospitals, Industrial Buildings. Airports, Convention Centers, and many more. Steel products have met and exceed expectations for decades.

The construction of Marryat & Scott doors and frames affords architects a remarkable degree of design freedom in nontypical situations, where a standard size or profiles product is inappropriate. With the proprietary steel construction techniques and capabilities of Marryat & Scott engineering, our design professionals have the opportunity to innovate and create virtually any solution and do so within a reasonable budget



# Projects

Marryat & Scott factory has provided services to many prestigious projects in Egypt, few of these are:

## 1- Hotels

First Residence at Giza - Four Seasons Giza –Alexandria  
Renaissance – El Sheikh Coast Sharm El-Sheikh –  
Meridien Macadi Bey Hurghada – Four Seasons  
Nile Plaza – San Stefano Complex Alexandria



## 2- Cinemas

City Stars – Family Cinemas  
Maadi – Alexandria City  
Center

## 3- Administrative Buildings

Enppi – Gupco Petroleum Co Maadi –  
Petroleum Air Line Services – PAS  
Khaldia–VodaFone 6th October  
City–Mobinil at Nile City–  
Smart Village– Pyramids  
Heights



## 4- Banks

Central Bank Egypt–Piraeus Smart Village– Audi Bank Pyramids  
Heights Barclays Kasr El Eini – Several Branches of Barclays – City  
Bank–United Arab Bank–Credit Agricole–Audi– BNP–CIB–  
National–Societe



### 5- Factories

Nestle 6th October City – Copack – Swiss Pharma- Novartis –Roussel Pharma  
6th October City – Al Ezz Steel Rebars Co. El Saddat City – Alexandria National  
Co. For Iron & Steel – Hot Strip Mill Al Ezz Ain Sukhna – Proctor & Gamble 6th  
October City – Al Masrya for Cement Ain Sukhna – Domty 6th October City –  
Suez Fertilizer

### 6- College

American College  
at New Cairo



### 7- Malls

Maadi Grand Mall – Carrefour  
Alexandria – Al Rehab Trade  
Center



### 8- Airports

Engineering Base  
Project 200B Egypt  
Air – Marsa Allam  
Airport



### 9- Power Stations

Cairo West – Al Arish – Ayoun Moussa – Nuclear Station Inshas –  
EDF Suez Cairo Regional Control Center – EDF Port Said



# Basic Door Requirements

1. A fire door must have a label attached
2. A fire door must be self-latching
3. A fire door must be self-closing
4. If a fire door is held open, it must be equipped with a listed heat responsive device, fusible link or a smoke detection device.
5. A fire door must be free of any obstructions which could prevent the door from operating properly, i.e., wedge door stops, chains, hook backs and floor holder
6. Only fire door hardware shall be used
7. A fire door must have steel bearing type hinges



8. Doors swinging in pairs that required astragals shall have at least one overlapping astragal. Pairs of doors within a means of egress shall not be equipped with an astragal that inhibits the free use of either leaf. A coordinator or open back strike should be used to ensure proper closing
9. Fire doors with glass lights (vision panel)
  - A. The glass frame and glazing bead must be metal
  - B. The glass must be labelled wire glass not less than 1/4 in thickness or as permitted by the labelling agency
  - C. Maximum allowable glass area, 100 sq inch per door leaf
10. Fire doors with fusible link louvers
  - A. Only listed louver can be used
  - B. Maximum louver size is 24" x 24"
  - C. Louvers are not permitted to be installed in doors with fire exit hardware or in stairwell

FLDL-UL Fusible Link Louver Detailed Drawings

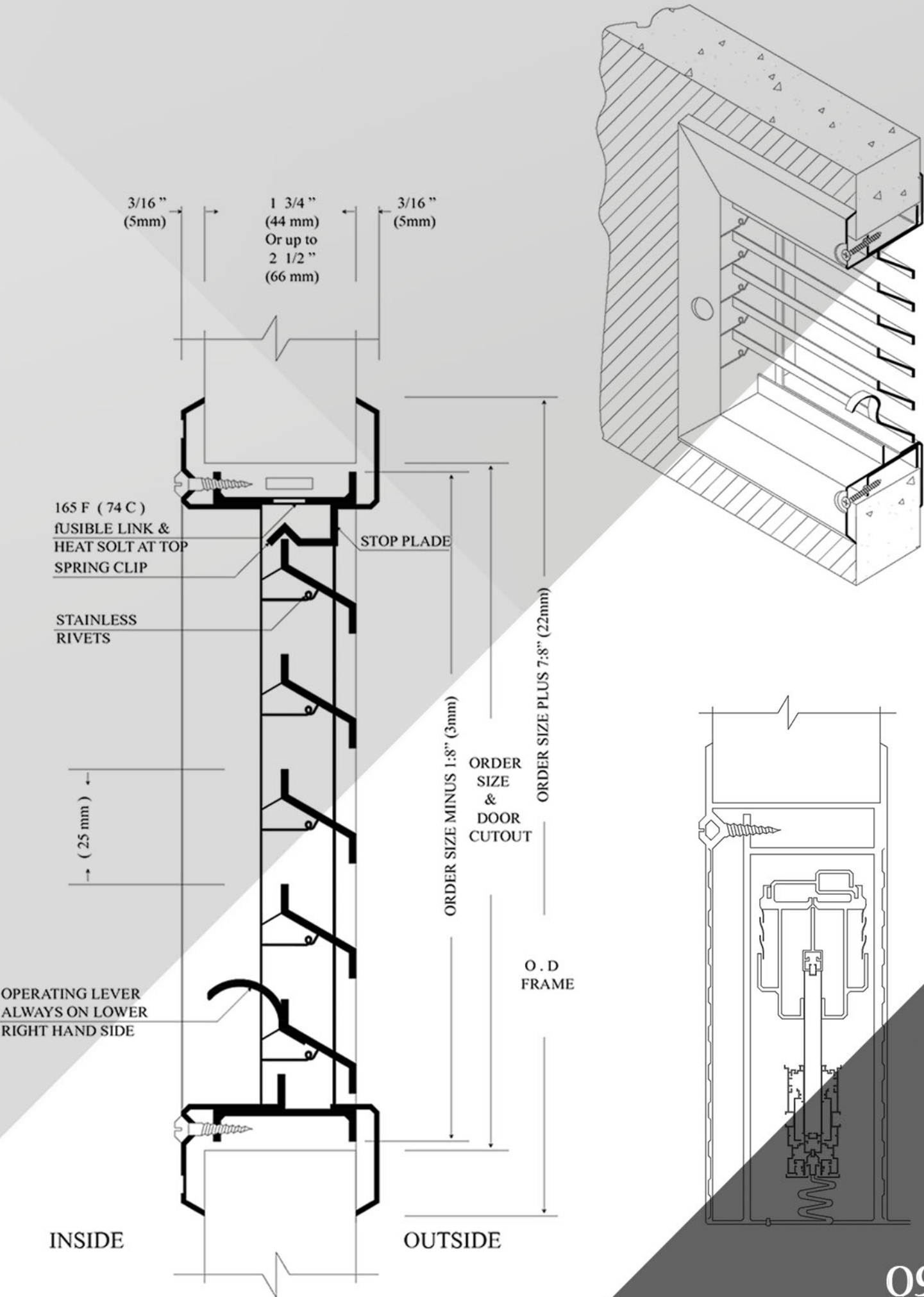

# Door Types



(FULL LOUVER)  
FL



(VISION LITE)  
V

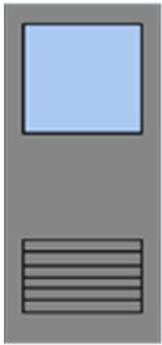

(GLASS LOUVER)  
GL

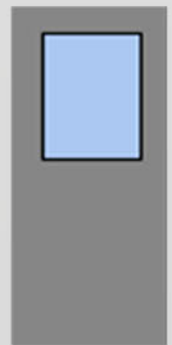

(HALF GLASS)  
HG

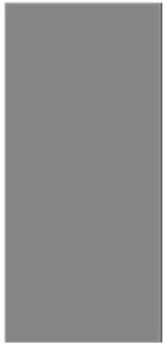

(FLUSH)  
F



(NARROW LITE)  
N



(DOUBLE LOUVER)  
DL

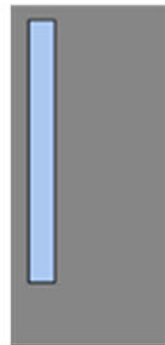

(NARROW LITE 2)  
N2

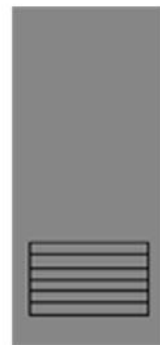

(BOTTOM LOUVER)  
BL



# Door Handling Legend

The term "Handing" or "Hand" of a door is applied to door, frames and hardware so as to indicate the direction of the swing of The door. Basically will either be Right Hand (RH) or Left Hand (LH). However, due to the door location and hardware we have to use



**LEFT HAND REVERSE**  
HINGES ON LEFT, OPENS  
OUTWARDS



**RIGHT HAND REVERSE**  
HINGES ON LEFT, OPENS  
OUTWARDS

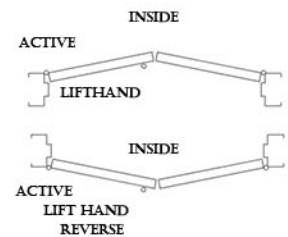

**LEFT HAND REVERSE**  
HINGES ON LEFT, OPENS  
INWARDS



**RIGHT HAND REVERSE**  
HINGES ON LEFT, OPENS  
INWARDS

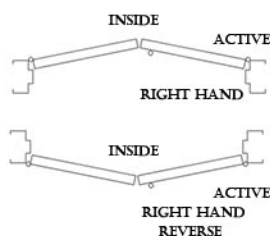

# Door Specifications

## 1. Door Construction

- Provide doors of 45mm thickness full flush construction fabricated from 1.5mm galvanized steel sheets.
- Face sheets shall be stiffened by vertical steel stiffeners 1.2mm thickness.
- Steel vertical stiffeners are placed no more than 150mm apart and welded no more than 150mm along their length.
  - Rock wool insulates the area between stiffeners.
  - Flush top channel and inverted bottom channel of 2.0mm steel thickness are welded to both faces sheets.
- Full flush doors are interlocked hairline seams on vertical edges and have no visible seams on faces.

## 2. Hardware Preparation

- Hinges preparation: Provide doors with 4.0mm thick steel hinge reinforcements with tapped holes welded to the door skins standard hinge preparation is to be for 4 ½" x 4" three preparation through 2,286mm height and four preparations over 2,286mm up to 3,048mm height.
- Lock preparation: Provide doors with 3.0mm thick steel formed lock reinforcement with tapped holes welded to the door skin; provide internal hardware reinforcements as required for each lock as specified.
- Closer and other reinforcements: Provide all doors with minimum 2.0mm steel reinforcement as necessary to support the hardware scheduled with tapped holes welded to the door skins.



# Door Specifications

## 3. Glazing and louvers

- Where required by the plans, doors are prepared for installation of glazing and louvers.

## 4. Painting

- After fabrication provide doors thoroughly cleaned and coated with electrostatic, lacquer, duco, or epoxy. As per customer requirement



## 5. Fire protection

- Provide labelled fire rated doors with ratings as specified in the plans.
- Fire doors are to be manufactured by Marryat & Scott Factory in accordance with the approved procedures by Intertek.



## 6. Labels

- Fire rated doors shall bear the appropriate labels. 7.

## Installation

- According to the American standards



# Doors Construction Features

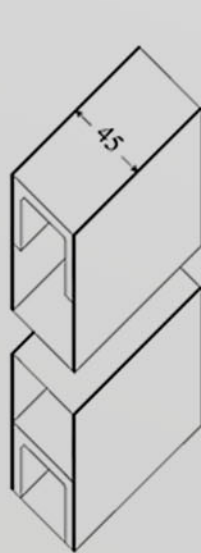

Flush Top and inverted bottom U-channels

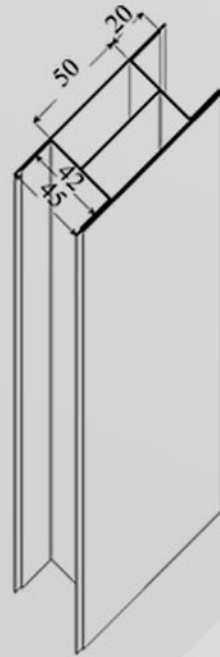

Vertical Steel Stiffner

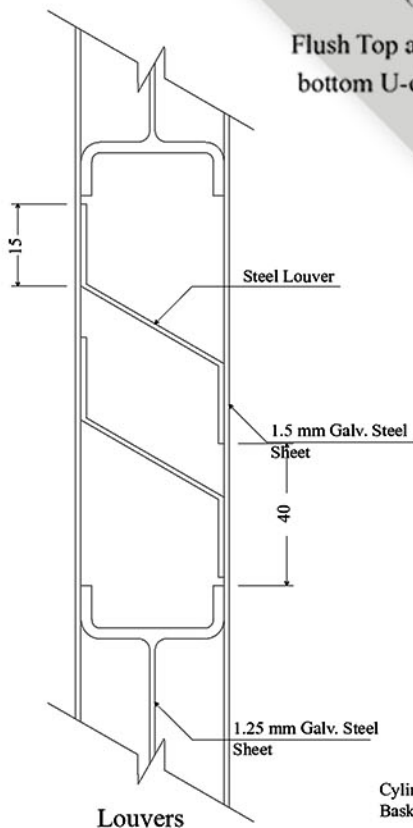

Louvers

Cylindrical (70mm) Basket

(Other Types Available)

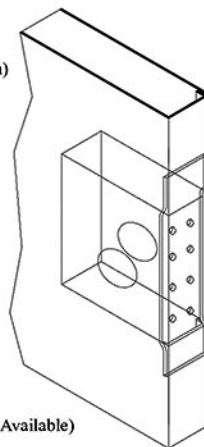

lock strike Preparation

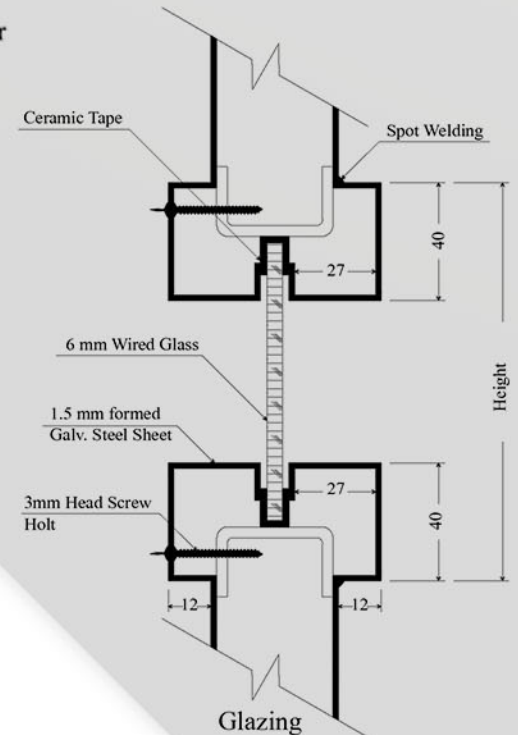

Glazing

ANSI A 156 7 Template

NON- HANDED  
(Other Types Available)

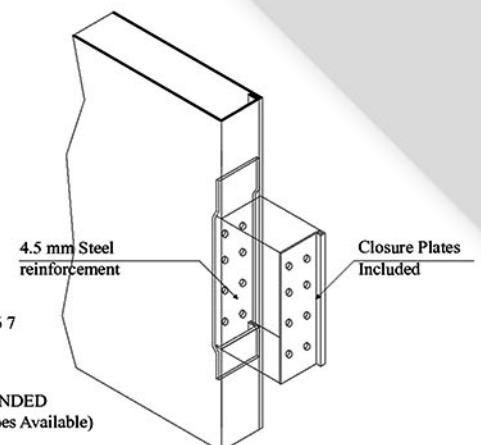

Hinge Preparation

# Types of Door Assembly

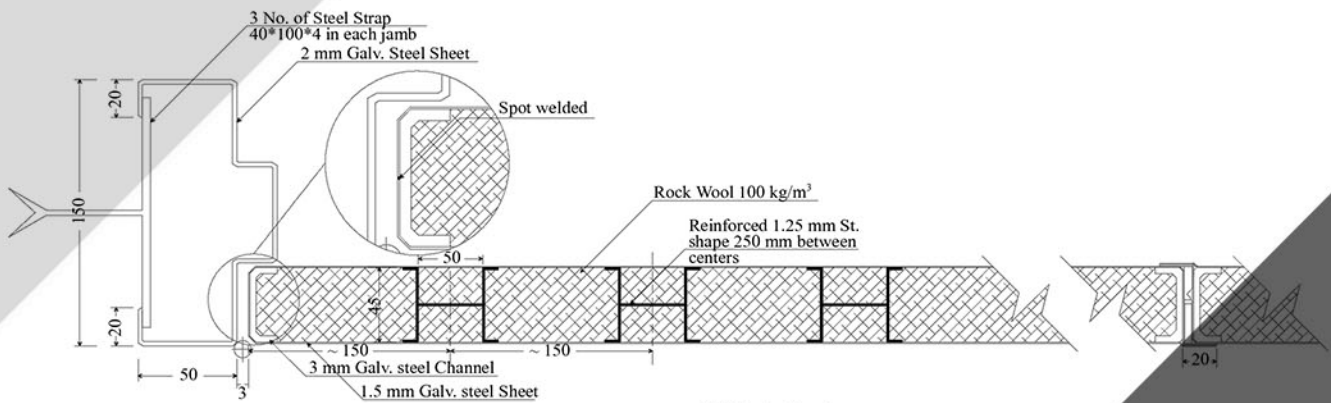
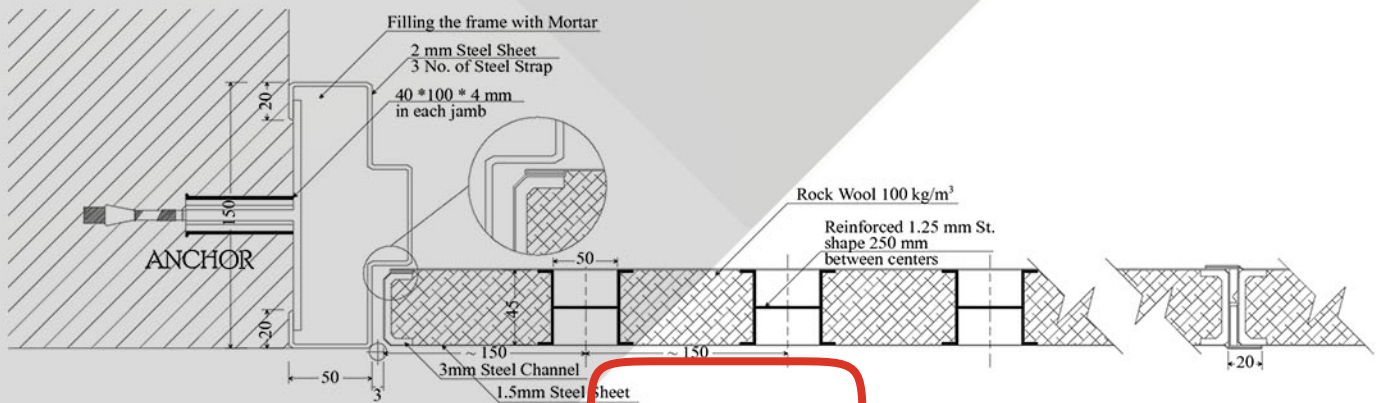
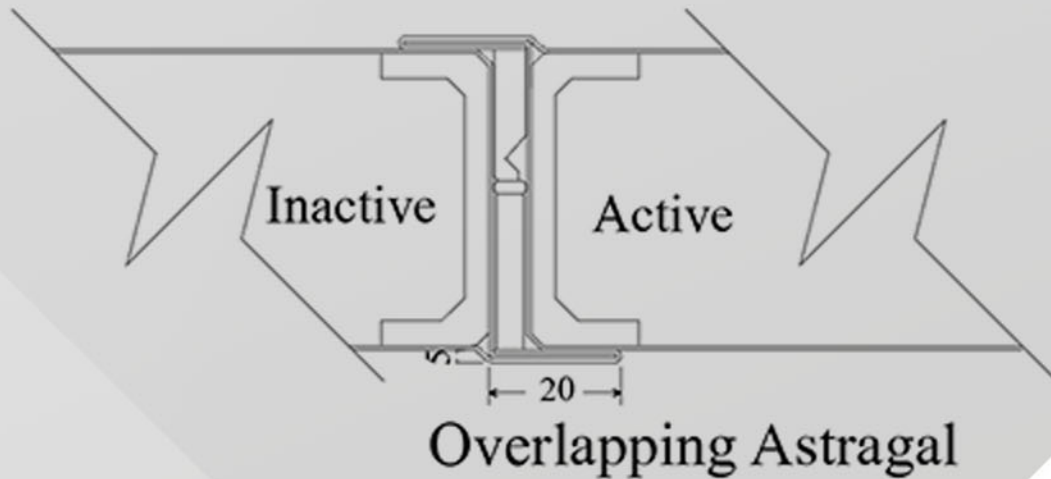

# Sliding Door Types

SD1 Manual





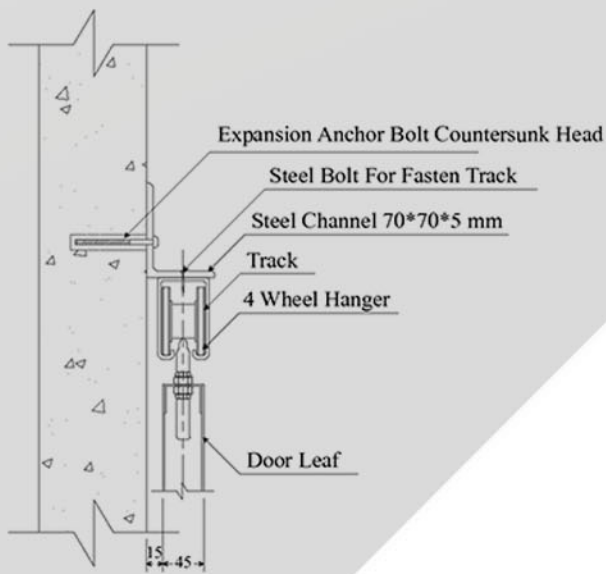
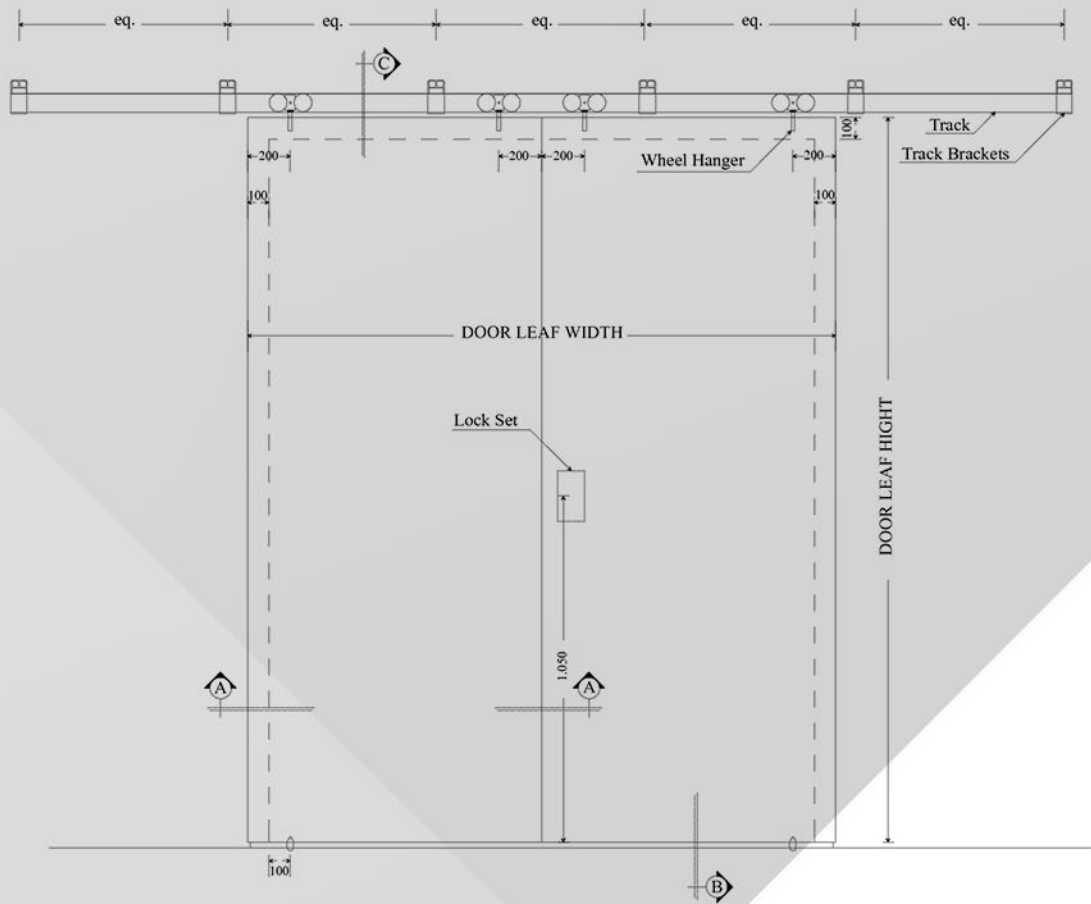

SECTION C - C

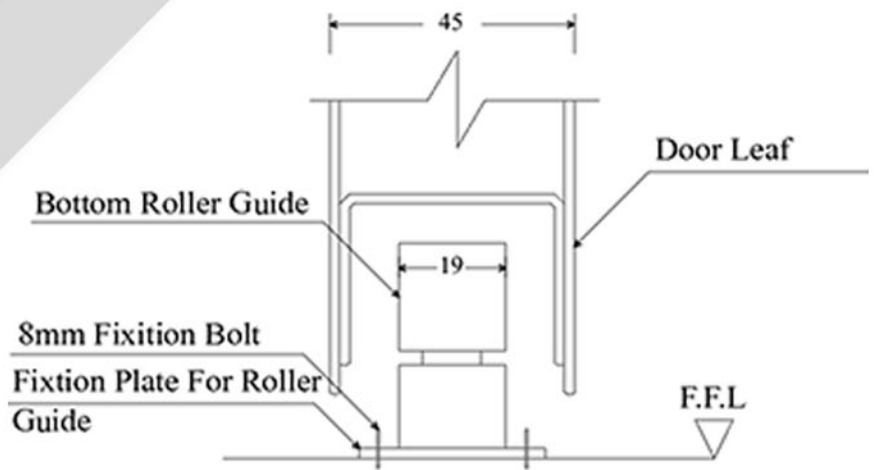

SECTION B - B

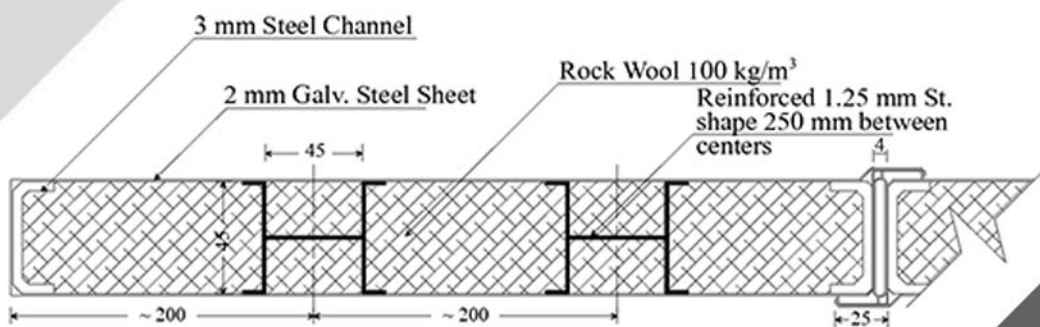

SECTION A - A

# Frame Specifications

## Door Frame Construction

- Provide metal frames of 2.0mm thick galvanized steel sheet
- Fabrication frames with mitered continuously welded corners
- Provide frames with suitable anchors or expansion shields for fixation with masonry, concrete, gypsum board and steel structure.
  - Provide frames with necessary reinforcement for surface applied hardware
  - Provide removable spreader bar across bottom of frames welded to jamb



- After fabrication provide frames cleaned and coated with epoxy primer finish paint to applied at the site after installation
- After fixation fill interior of frames with cement / sand mortar grouting



# Frame Profiles

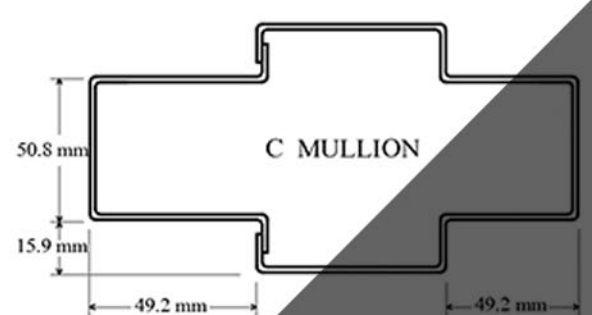
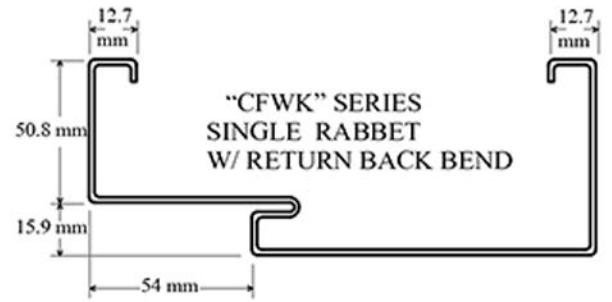
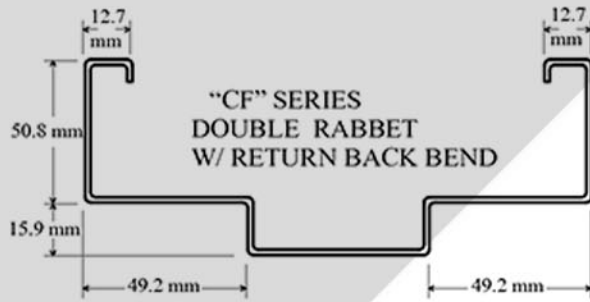
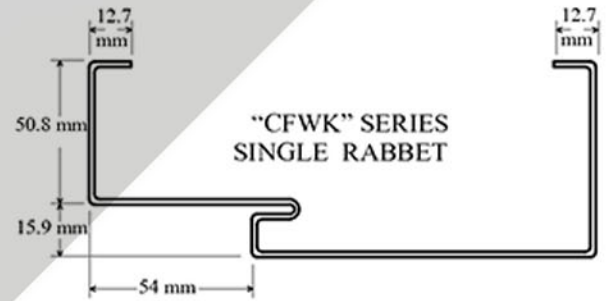
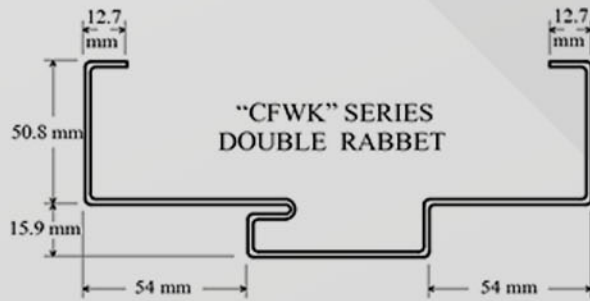
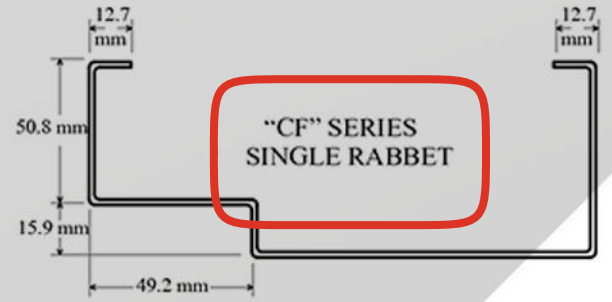
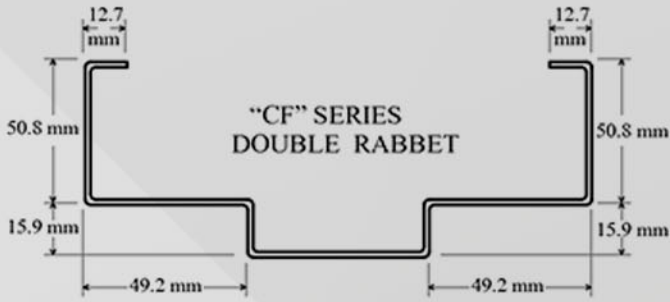



# Fire Rated Steel Window

We have test certification from Intertek ELT SEMKO USA 120 Minute and 60 Minute fire resistance test of glass steel window assemblies was tested successfully by Omega Point laboratories Inc. USA, accordance with NFPA 257 standard methods which is identical or very similar to the following standard test methods:

UL 9

UBC 7-4

ASTME 163



- The window assembly consisted of a single pane of 6mm fire-rated glass with (12mm X 12mm) wire mesh grid.
- The window consisted of a double pane with (12mmX12mm) on pane being 6mm fire-rated glass with wire mesh grid exposed to the fire and the other pane being 6mm tempered glass on the unexposed side.
- The double pane window also had an air pocket created by a 6mm spacer.
- The window frame was manufactured from 2mm galvanized steel.
- Window frame was attached to the masonry wall using Flat Head Lock/Bolts.
- A ceramic tape (normal 15mm wide and 3mm thick) was placed between the face of the window frame and the glass on both sides.

# Steel Window Frame Section

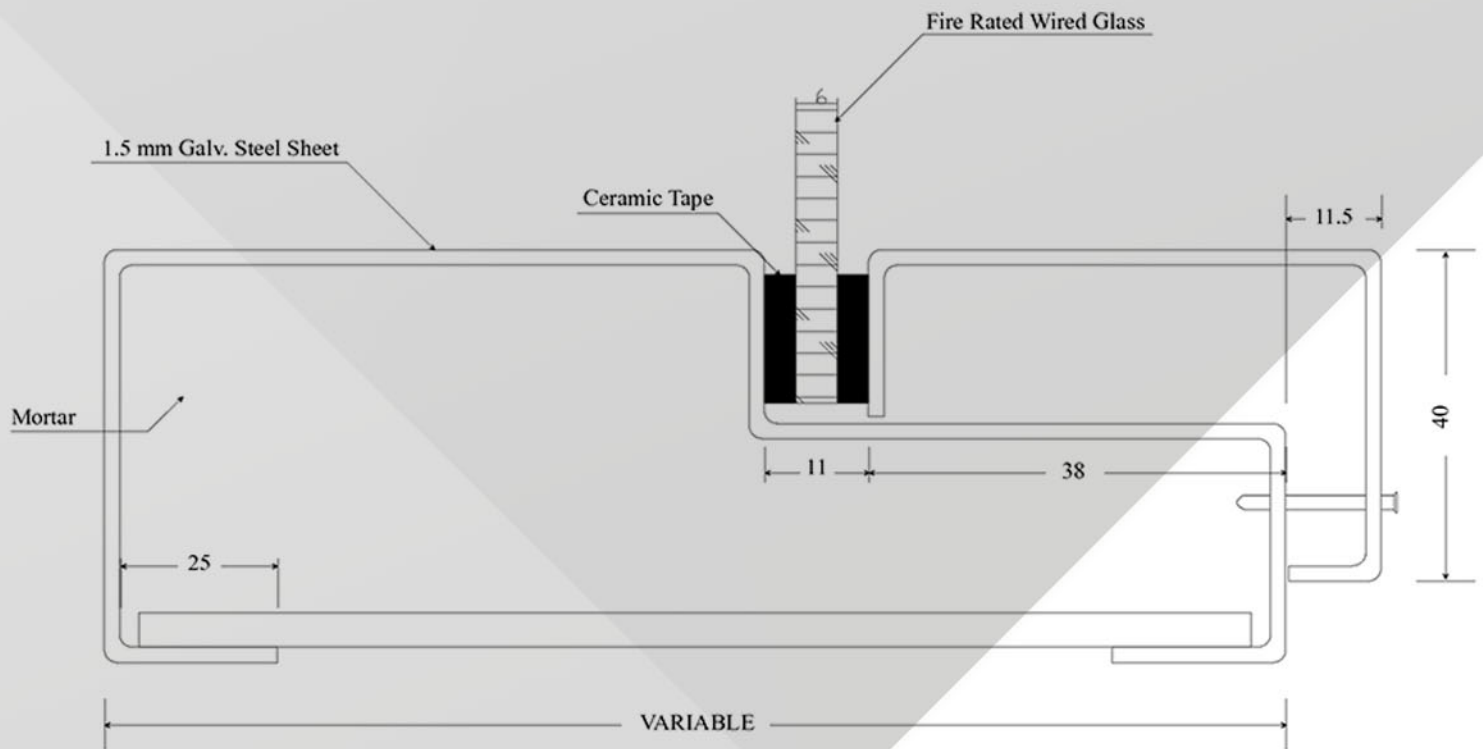

SINGLE STEEL WINDOW

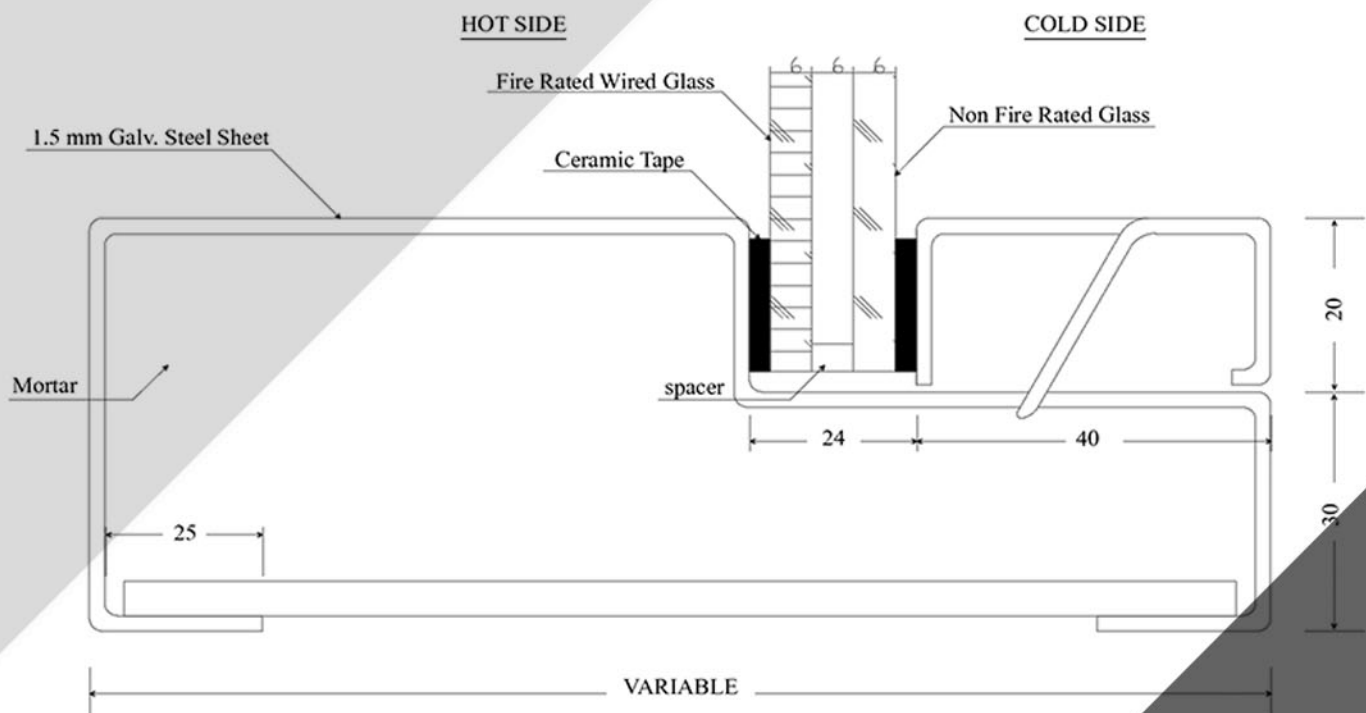

DOUBLE STEEL WINDOW

**Marryat & Scott**

**Egypt**

Nissan Factory

Bavarian Auto  
Group

Dandy Mall

Alexandria desert road

Emarat gas station

## **Marryat & Scott**

Headquarters & Factory  
Kilo 28 Cairo - Alexandria Desert  
Road, Abu Rawash Industrial Zone  
Email: [hesham.bahgat@marryatscott.com.eg](mailto:hesham.bahgat@marryatscott.com.eg)  
Phone: 353 90 040  
Fax: 353 91 003  
Mobile: 01272297551